

Villa					Porch	Terrace	Solarium	Basement		
-------	--	--	--	--	-------	---------	----------	----------	--	--

1	433,08	141,5 m2	3	4	17	9,5	52,5	83,5	2025	730.000,00 €
2	354,56	141,5 m2	3	4	17	9,5	52,5	92,8	2025	680.000,00 €
3	367,33	141,5 m2	3	4	17	9,5	52,5	96,7	2025	<b>RESERVED</b>
4	377,84	141,5 m2	3	4	17	9,5	52,5		2025	<b>RESERVED</b>
5	380,89	141,5 m2	3	4	17	9,5	52,5		2025	<b>RESERVED</b>
6	383,34	141,5 m2	3	4	17	9,5	52,5		2025	<b>RESERVED</b>
7	385,65	141,5 m2	3	4	17	9,5	52,5		2025	570.000,00 €
8	380,86	141,5 m2	3	4	17	9,5	52,5		2025	<b>RESERVED</b>
9	372,33	141,5 m2	3	4	17	9,5	52,5		2025	565.000,00 €
10	363,47	141,5 m2	3	4	17	9,5	52,5		2025	<b>RESERVED</b>
11	350,21	141,5 m2	3	4	17	9,5	52,5		2025	545.000,00 €
12	334,39	141,5 m2	3	4	17	9,5	52,5		2025	535.000,00 €
77	318,16	141,5 m2	3	4	17	9,5	52,5		2025	495.000,00 €
14	338,86	141,5 m2	3	4	17	9,5	52,5		2025	<b>RESERVED</b>

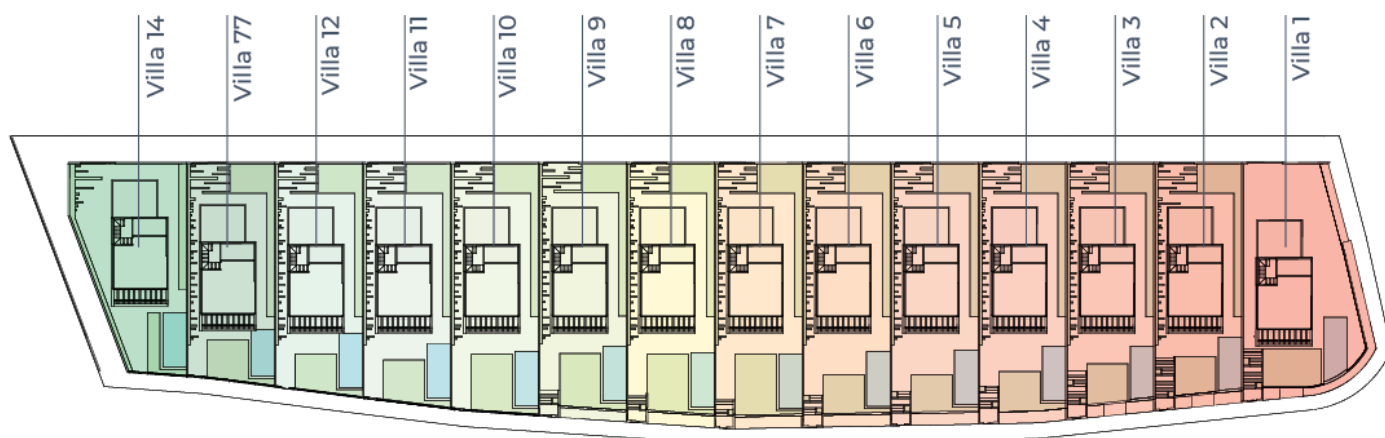

#### INCLUDED

- Kitchen with appliances
- Swimming pool 7 x 3 m
- Fully furnished bathrooms
- Air conditioning preinstallation
- Electric blinds
- Garden and plot according to the plan

#### NOT INCLUDED

- Furniture
- Basement are diaphanous
- Air conditioning machines
- Extra plants and tiles
- VAT 10%
- Extras are available at request

\* All surfaces may change depending the project